

NEWSLETTER 16

Dear Reader,

This newsletter presents progress up to end of **March 2006**, and is primarily intended for people involved in the project and might not give a complete picture of the project. The Newsletter is also found on the Buffalo City Intranet and on Swedesurvey's homepage. Please also note that the Newsletter has an informal character and that the content does not imply official endorsement by the Local Authority of Buffalo City (BCM).

If you have ideas or questions about the project, please contact christer.kjerneberg@swedesurvey.se

New Team Member

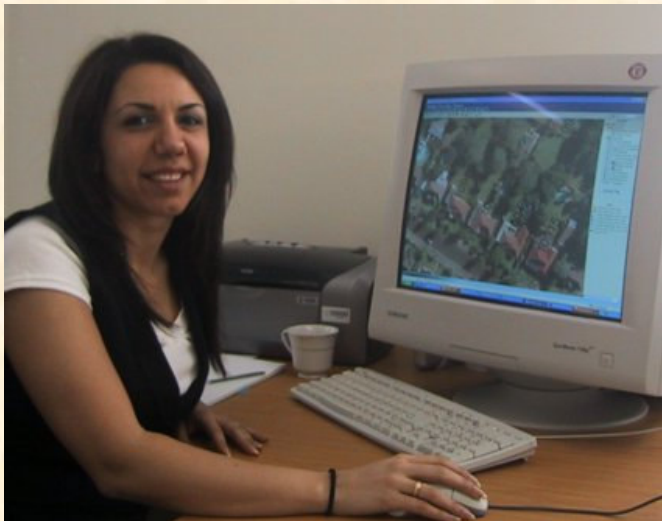

We welcome Ms. Maryam Zeitoni, a 'Young Consultant', to the project work team. The 'Young Consultants' program is initiated and sponsored by Sida and gives young professionals with an interest to work abroad an opportunity to test foreign employment environment. Maryam has a Master in Geographic Information Technology and will be working with the project for 6 months.

PROGRESS REPORT PHASE III PROJECTS

Business plans have been prepared for each of the four primary projects for GIS Phase III. These plans have been accepted and approved by the Task Team. Although the Business plans approval process has only recently been completed, development on the

individual projects has already been started.

GIS Support for Customer Care

It has been decided that three pilot Community Support Centres (CSC) initially would be set up in King William's Town, Mdantsane and Duncan Village.

The project objective is to assist BCM Communications & Customer Service Department under Corporate Services to synchronize the information requested in the CSC and hereby utilize the existing corporate GIS and propose additional GIS tools to facilitate the informative function of a CSC.

Resulting from an analysis of the customer support requirements, many of the needs of the customers support centres have already been addressed through the **GISstext** project, currently being developed as a joint project between the GIS Unit and the IT department. Several new modifications and additional modules have been identified for inclusion into the application.

The HIV/AIDS support centres have being added to the GIS along with a database of services available at these centres. In future citizens will be able to easily identify their closest HIV/AIDS support centre by contacting the customer care centre or community support centres.

Unfortunately due to the non-availability of GIS on the Internet, this information will not be available to the general public.

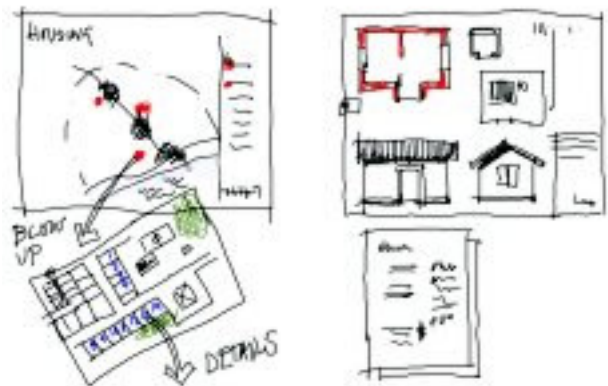

The customer support centre staff requires extensive training on the support tools available in the centres. Introductory training has been identified and the staff have been included in the scheduling.

Municipal Safety and Security GIS Application

The aim is to create a GIS Application in a test area, which would enable one to draw statistical information from various sources such as Municipal Police, SAPS, Accidents database, TCS, Fire & Rescue and Disaster Management, and overlay it with various layers to produce an analytical report. Input from the SAPS has not as yet been included in the project as there has not yet been any positive response to the letter requesting their cooperation. Planning on the project has however gone ahead using statistical information extracted from internal datasets. An interesting opportunity to combine this project with the MURP (Mdantsane Urban Renewal Programme) project "Violence Prevention Project" has been identified. Both projects are addressing similar issues and by combining resources and expertise, a more thorough study will result. If data can be retrieved the test area will be one of the three police stations in Mdansane.

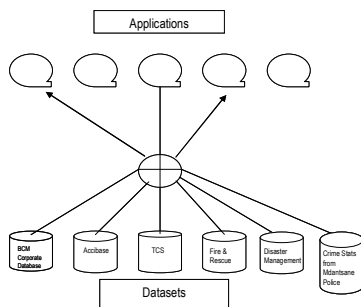

Municipal Burial Management GIS Application

This study is divided into three sub projects:
Cemetery Management Pilot Project



The East Bank Cemetery was chosen for the pilot study. Sample data was extracted from the manual paper based record system and together with digital photos taken of the headstones were linked to the spatial position of the graves. The management system developed from this project will be used to manage all the formal burial sites in the municipality in the future. Recommendations and methodologies along with resource

requirements will be produced, from this pilot, to address the needs to incorporate all the formal burial sites into the application.

Sub project: Burial Management.

As with the Safety and Security application, there is also an opportunity to combine the MURP and GIS projects that are both focusing on identifying and mapping unofficial burial sites within the municipality.

Sub project: Identification of new cemetery sites

The current official cemeteries are becoming full and it has become critical that additional suitable land be identified for new cemeteries. It is proposed that by using GIS technology suitable land should be identified for additional cemetery sites.

Municipal GIS for Cultural and Heritage GIS Application

Although the potential for producing a very useful application exists within this project, very little progress has in fact taken place. At this stage it has been found to not be feasible to continue the development due to lack of manpower for the data capturing.

Councilor Training on GIS



A local government election was held in early March and now there are a number of new ward councilors in power. A pilot training based previous course was conducted on 4 April. Seven councilors attended and their general impression stated in the course evaluation was satisfactory. The councillors have shown great interest to participate in the training; about 33 have applied besides from the ones who participated in the pilot training want to participate.

BACKGROUND

The Governments of South Africa and Sweden have signed an agreement concerning co-operation in the field of urban development. The overall objective of the agreement is to establish the framework for co-operation in order to reduce the physical and social effects of segregation and create a more integrated environment to benefit the urban poor. **Swedesurvey** has been given the responsibility to assist Buffalo City, South Africa, in building a comprehensive GIS that will support the objectives of the Integrated Development Planning.